



Nine Eagles™

BRAVO III

NE R/C312A C-axial Helicopter
Manual



NOTHING FLIES LIKE NINE EAGLES

■ 312A100310

Manual

Welcome to be a Nine Eagles™ Helicopter pilot!

To ensure safe use, please read this manual thoroughly before flying the helicopter. If you have never flown an RC Helicopter before, The Bravo III is your best choice!

Catalogue

Introduction.....	2
Warning and FCC Information.....	3
Specification.....	6
Product List.....	7
Exploded View.....	7
Transmitter Control Identification.....	11
How to fly.....	14
Operation Test.....	19
Choosing a Flying Area.....	22
Flight Training	22
Notify Items.....	24
Miscellaneous.....	24

Introduction

NE R/C 312A Co-axial helicopter Bravo III the latest 2.4GHZ4-channels single helicopters .It has excellent control function and advanced balanced operative system with easy operation and fly stabilit . It is the best choice for the pilot to learn how to fly .

NE R/C312 the min- leisure indoor helicopters which research and developed by NineEagles™. It has the min-volume ,light- weight that can fly in small range . The pilot can absolutely enjoy this leisure sport.

THREE UNIQUE INVENTION PATENT in the world

- A. Allow Mode1 to Mode2 only by antenna***
- B. Easy installation of battery and Charge directly on the transmitter***
- C. Display screen show voltage, electricity and data when hovering, it make helicopter fly at will. if you open the transmitter switch, each heli can fly to sky in the straight line, moreover it can hover.***

Warning and FCC Information

■ Warning and FCC Information

The Nine Eagles™ NE R/C 312A (Bravo III) is not a toy. Children under 14 years old are strictly forbidden from flying this helicopter.

You must fly this helicopter safely.

When flying or preparing the helicopter for flight you should strictly adhere to the instructions. Ensure that yours and other people's hands, and face are kept away from the rotating parts.

Always use the helicopter indoors or in outdoor areas that are free of wind.

Never fly close to or above others.

Always unplug the helicopter battery before turning off the transmitter when the helicopter is stopped.

Helicopter uses a lithium polymer battery. Always adhere to operating instructions for the lithium polymer battery to avoid accidents such as combustion or explosion.

Always use a genuine Nine Eagles™ charger and power adaptor designed for this helicopter.

Always unplug the charger and adapter from the electrical outlet after completion of each charge.

Never overcharge the battery, avoid use in direct sunlight or near fire. Ensure the battery is kept dry.

Never store or transport the battery with metal objects.

Never disassemble the battery.

Never use wet hands when in contact with the charger, battery or power adaptor.

When you fly the helicopter, keep distance from other electrical equipment, magnetic objects, wireless devices. etc, to avoid interference and accidents.

This device complies with part 15 of the FCC rules. Operation is subject to the following two conditions:

- 1) This device may not cause harmful interference, and
- 2) This device must accept any interference received, including interference that may cause undesired operation.

NOTE: This equipment has been tested and found to comply with the limits for a Class B digital device, pursuant to part 15 of the FCC rules. These limits are designed to provide reasonable protection against harmful interference in a residential installation. This equipment generates, uses and can radiate radio frequency energy and, if not installed and used in accordance with the instructions, may cause harmful interference to radio communication. However, there is no guarantee that interference will not occur in a particular installation. If this equipment does cause harmful interference to radio or television reception, which can be determined by turning the equipment off and on, the user is encouraged to try to correct the interference by one or more of the following measures:

- 1) Reorient or relocate the receiving antenna.
- 2) Increase the separation between the equipment and receiver.
- 3) Connect the equipment into an outlet on a circuit different from that to which the receiver is connected.
- 4) Consult the dealer or an experienced radio/TV technician for help.

■ **Instructions for Disposal of WEEE by Users in the European Union**



This product must not be disposed of with other waste. Instead, it is the user's responsibility to dispose of their waste equipment by handing it over to a designated collection point for the recycling of waste electrical and electronic equipment. The separate collection and recycling of your waste equipment at the time of disposal will help to conserve natural resources and ensure that it is recycled in a manner that protects human health and the environment. For more information about where you can drop off your waste equipment for recycling, please contact your local city office, your household waste disposal service or where you purchased the product

■ LiPo Battery Safety Guidelines



Lithium Polymer batteries are significantly more volatile than alkaline or NiCd/NiMH batteries used in RC applications. All manufacturer's instructions and warnings must be followed closely. Mishandling of LiPo batteries can result in fire. Always follow the manufacturer's instructions when disposing of Lithium Polymer batteries.

If you are clear about charge the battery included with this product, please refer to the advice of your local hobby shop.

WARNING

Charging and discharging the batteries may cause, serious injury to persons and damage to property. The user of this battery agrees to accept responsibility for all such risks. Nine Eagles™, its affiliates, distributors, and retail partners can not control the use, application, charging or installation of this product and shall not be held responsible for any accident, injury to persons, or damage to property resulting from the use of this product. Read all safety guidelines, charging instructions, and battery disposal instructions before using batteries. Store battery packs out of the reach of children and pets. Children under the age of 18 must be supervised by a responsible adult. Children under 14 years of age should not be permitted to use this product under any circumstances. This product contains chemicals known to the State of California to cause Cancer, Birth Defects and other Reproductive Harm.

LI-PO BATTERY WARRANTY

This product is warranted against defects in original material and workmanship only. No term warranty is offered with this product. In no case shall Nine Eagles™ liability be greater than the actual retail purchase price of this product.

SPECIFIC SAFETY GUIDELINES

1. Store in a fire proof container and charge on an open fire proof surface.
2. Charge in a protected area devoid of combustibles. Never leave the charging process unattended.
3. In the event of damage carefully remove the battery to a safe place to observe for at least half an hour. Damaged batteries are likely to explode. Never attempt to charge a damaged battery, no matter how slight the damage. Dispose of damaged batteries as the instructions below.
4. Only use the Nine Eagles balanced charger designed for this battery. Never use

- chargers designed for Ni-CD batteries. If the batteries show any sign of swelling, remove them to a safe place outside as they could erupt into flames.
5. MOST IMPORTANT – Never plug in a battery and leave to charge overnight. Serious fires have resulted from this practice.
 6. Do not attempt to make your own battery packs from individual cells.

If the battery pack involved in a crash or is otherwise damaged

1. Remove the pack from the model.
2. Inspect the pack for damage to the wiring or connections
3. If necessary, disassemble the pack and dispose of any damaged cells

Disposal of Li-PO batteries

1. Put the pack in a safe open area and connect a moderate resistance across the cell terminals until the cell is completely discharged.
CAUTION: The pack may get extremely hot during the discharge
2. Puncture the plastic envelope and immerse in salt water for several hours.
3. Place in your rubbish bin.

Specification

Model No:	NE R/C 312A
Rotor Diameter:	7.40"(188mm)
Overall Length:	8.62"(219mm)
Weight:	1.09oz(31g)
Power System:	φ 7mmMotor x2pcs
Battery:	1-cell 3.7V 110mAh Li-PO

Product List

Description	QTY
Bravo III	1
2.4GHz Transmitter	1
Li-Po Battery	1
AA Battery	4
Screwdriver	1

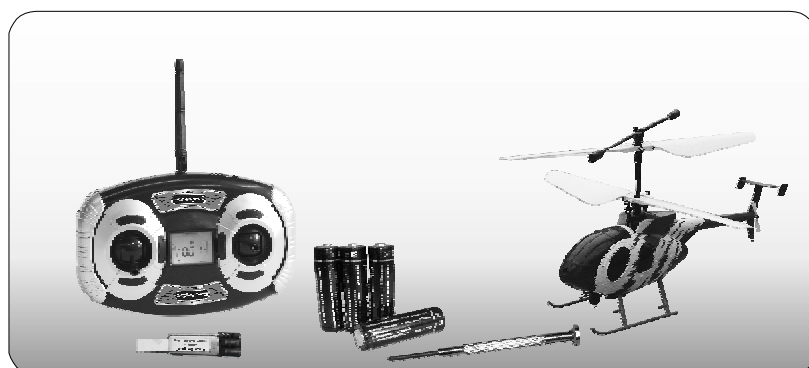

Warrant: *NineEagles guarantees all the helicopters have been strictly inspected, tested before export from factory. Please contact your local distributor to get the technology support to purchase the spare parts and replacement. We have the detail exploded rawing to help you identify the broken spare parts.*

Exploded View

⑦

www.NineEagle.com

■ Exploded View of Bravo III

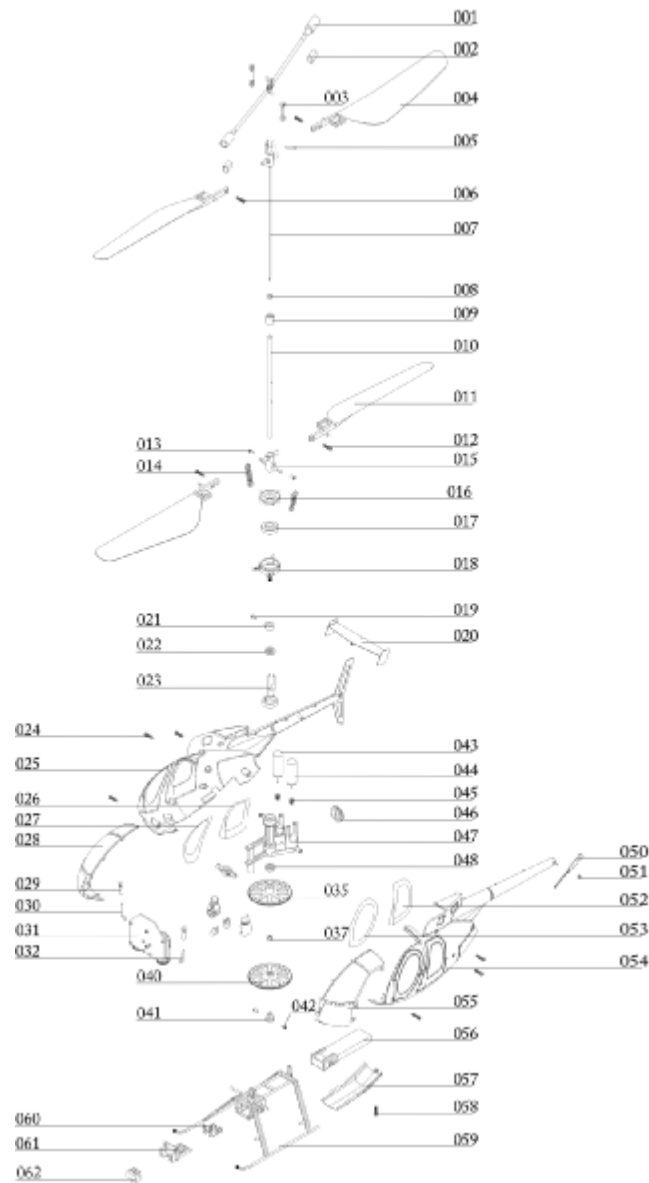

■ Part list

NO	Materiel apellation	Description	Unit	Qty
	NE4312001	Cabin Set		
025		Right cabinet	PCS/SET	1
054		Left cabinet	PCS/SET	1
055		Left hood	PCS/SET	1
028		Right hood	PCS/SET	1
053		Left front window	PCS/SET	1
027		Right front window	PCS/SET	1
052		Left rear window	PCS/SET	1
026		Right rear window	PCS/SET	1
046		Nozzle	PCS/SET	1
020		Horizontal tail	PCS/SET	1
050		Tail blade	PCS/SET	1
051		Tail nut	PCS/SET	1
057		Battery cover	PCS/SET	1
	NE4312002	Rotor Bades Set		
004		Upper rotor	PCS/SET	2
011		Lower rotor	PCS/SET	2
	NE4312003	Fly bar set		
001		Fly bar	PCS/SET	1
002		Weight Block	PCS/SET	2
007		Inner shaft	PCS/SET	1
015		Under shape holder	PCS/SET	1
	NE4312004	Swashplate		
016		Upper swashplate	PCS/SET	1
018		Lower swashplate	PCS/SET	1
017		Bearing MR106	PCS/SET	1
	NE4210008	Outter shaft set		
009		Bearing housing	PCS/SET	1
010		Outer shaft	PCS/SET	1
	NE4312011	Main Frame Set 2		
047		Main frame	PCS/SET	1
023		Sliding chute	PCS/SET	1
	NE4210010	Gear set		
035		Upper gear	PCS/SET	1
040		Lower gear	PCS/SET	1
	NE4312006	Ball linkage rod set		
003		Uppert ball linkage rod	PCS/SET	2
014		Middle ball linkage rod	PCS/SET	2

NO	Materiel apellation	Description	Unit	Qty
029		Lower connecting plastic set	PCS/SET	2
030		Push and pull wire	PCS/SET	1
032		Right push and pull wire	PCS/SET	1
	NE4312010	Landing Skids Set 2		
059		Landing skids	PCS/SET	1
060		Battery needle 2	PCS/SET	2
061		Power switch mounting plate	PCS/SET	1
062		Power switch	PCS/SET	1
	NE4210016	Bearing set		
022		Bearing MR63	PCS/SET	1
048		Bearing MR63	PCS/SET	1
008		Copper sheath	PCS/SET	1
037		Copper sheath	PCS/SET	1
	NE4210017	Fixed circle set		
021		Outer shaft fixed ring	PCS/SET	1
041		Inner shaft fixing set	PCS/SET	1
	NE4312008	Screw set		
019		Screw ST1.3 X 5PA	PCS/SET	1
024		Screw ST1.3 X 5PA	PCS/SET	6
058		Screw ST1.3 X 5PA	PCS/SET	1
006		Screw ST1.3 X 5PA	PCS/SET	2
012		Screw ST1.3 X 5PA	PCS/SET	2
013		Screw PM1.2 X2.5	PCS/SET	2
042		Screw PM1.2 X2.5	PCS/SET	2
	NE4902003	Motor set		
044		Motor1	PCS/SET	1
043		Motor2	PCS/SET	1
045		Motor and gear	PCS/SET	2
056	NE4901001	Battery set	PCS/SET	
031	NE4617001	Receiver set 2	PCS/SET	
005		Fixed pin balance bar	PCS/SET	1

Transmitter Control Identification

When the transmitter is at MODE1:

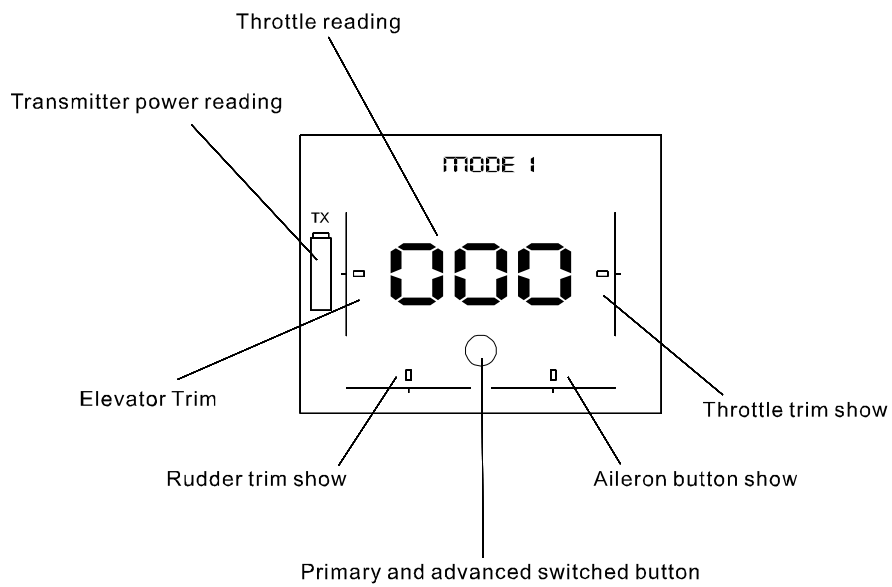
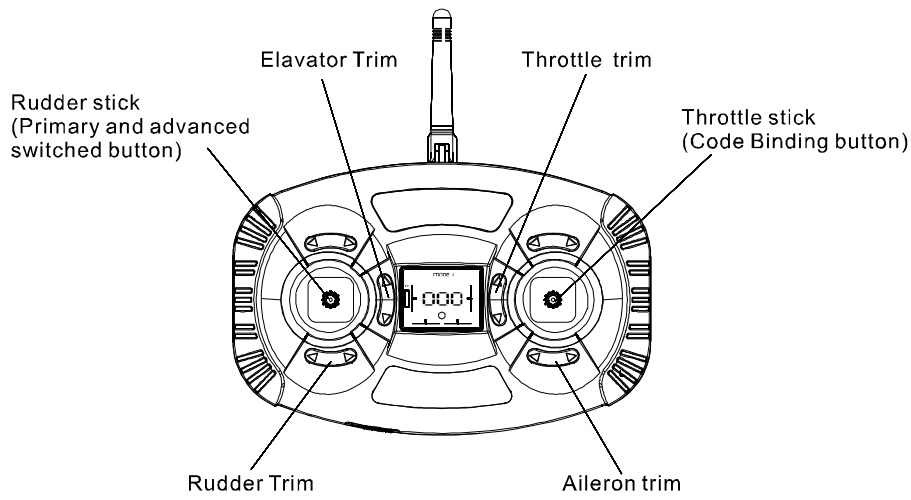

When the transmitter is at MODE2:

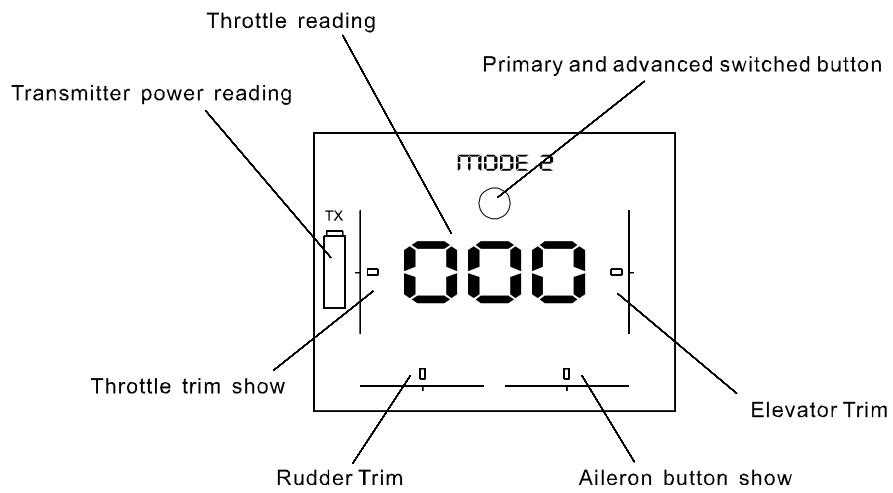
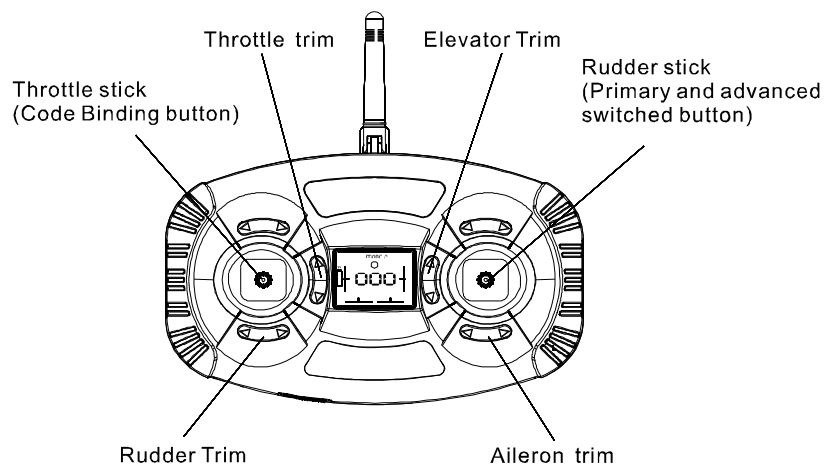

■ Set up the Primary and Advanced Control Switch

We have set up the primary and advanced control model to meet the different fun requirement.

1. Turn on the transmitter ,check the present model of transmitter .if the mode is advanced the illustration as left, if the primary mode the illustration as right .

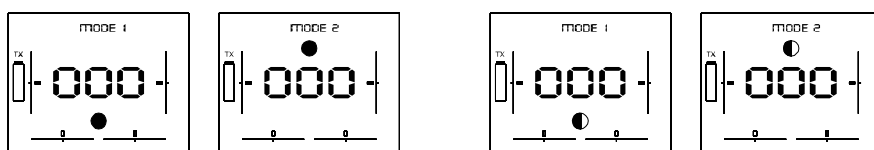

Advanced mode

Primary mode

2. Press the button to switch the mode of the primary and advanced.

Note: *This throttle curve in the low rate mode is also different than it is in the high rate mode. This makes it much smoother and easier to control the throttle when in the low rate mode.*

The advanced mode is suitable for the experienced pilot. We suggest you choose the primary mode when you first flight the helicopter.

■ Transmitter Mode Switch Function

In order to meet the different customer requirement, we use the transmitter with the mode switch function, it can switch between the left and right hand.

Please go ahead the following process to switch the mode from Mode2 to Mode1 :

1. Turn off the transmitter.



PICTURE 1

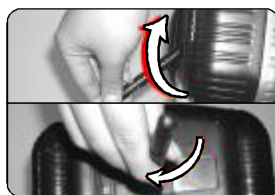

PICTURE 2



PICTURE 3

2. Turn off the fixed nut on the antenna and clip.(PICTURE 1)
3. Reverse the antenna 90 degree , circumrotate the antenna shaft 180 degree,then make the antenna to cling another side of transmitter.(PICTURE 2)

4. Re-install the nut and the fix clip on the antenna.(PICTURE 3)
5. Turn off the transmitter and to be the mode1 operation check.

■ **Battery Charging**

A. Ensure the transmitter contains batteries with enough power.

B. Take off the battery cover of the transmitter.



C. Slide the Li-PO battery into the slot on the transmitter until you make the connection successfully , the green indicator on the charger will illuminate.

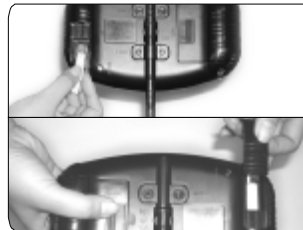

D. When the battery is fully charged the green light will be off.

How to Fly

1. Take off the transmitter cover
2. Install four of the included AA batteries in the transmitter
3. Turn on the power , check if there is any content on LCD.
4. Slide the Li-Po battery into the battery slot on frame of helicopter (usually with the label on the battery facing outward). However, be sure to check proper alignment and polarity before proceeding to the next step.

Start process:

1.

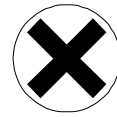

Shut down process:



www.NineEagle.com